

8 7 6 5 4 3 2 1

D

C

B

A

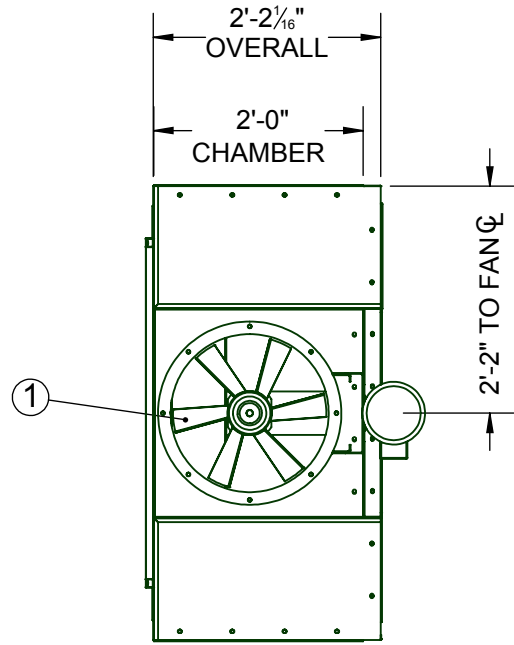

**PLAN VIEW**

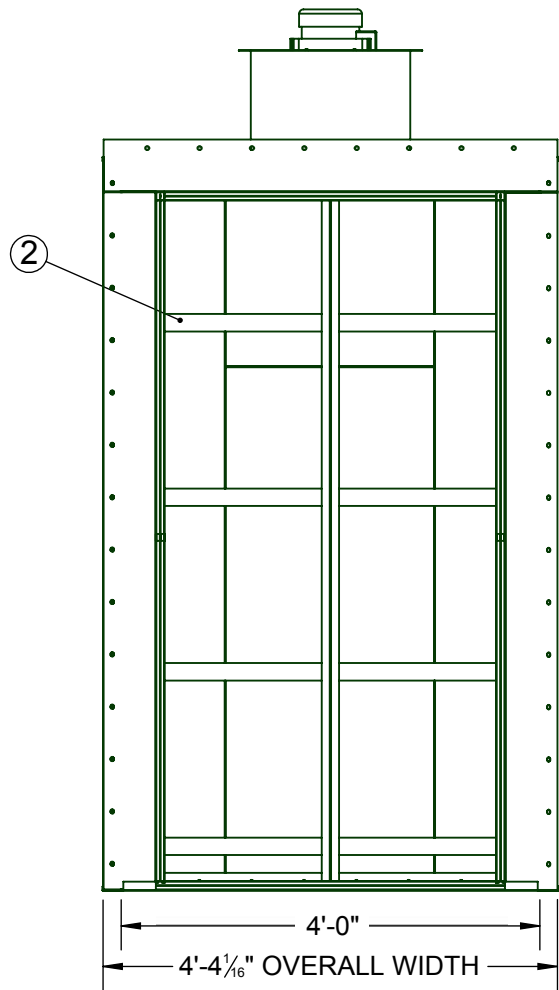

**FRONT VIEW**

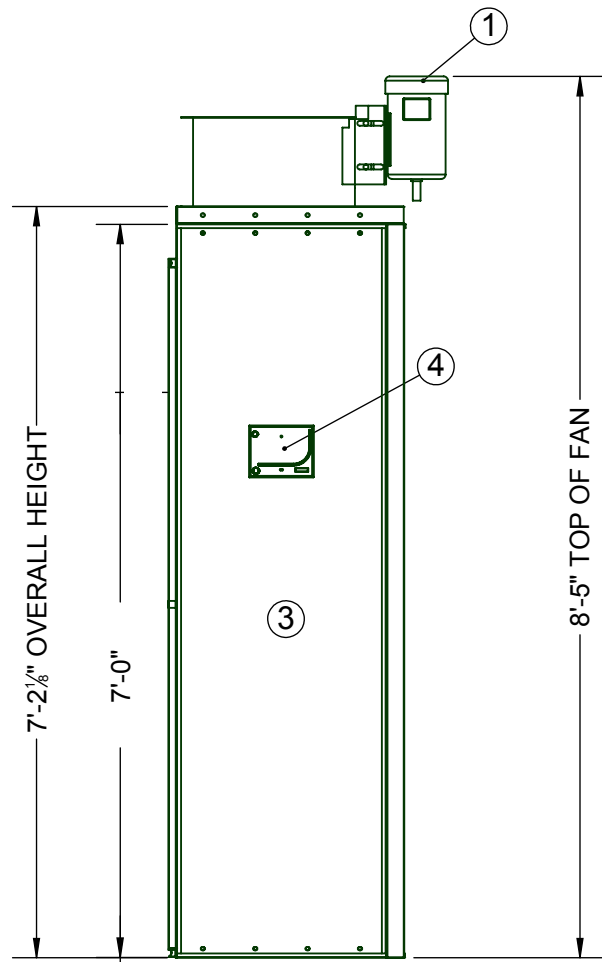

**SIDE ELEVATION**

ITEM	QTY.	Description
1	1	18" $\phi$ TUBEAXIAL FAN; RATED FOR 3,500 SCFM EXHAUST @ 1/2" SP; DRIVEN BY 3/4 HP ODP TYPE MOTOR
2	1 LOT	EXHAUST ROLL FILTER W/ ASSOCIATED HARDWARE & TOOLS
3	1 LOT	18 GA. GALVANIZED STEEL SHELL
4	1	MANOMETER
5	1	1/2" AIR SOLENOID VALVE (NOT SHOWN)

D

C

B

A

8 7 6 5 4 3 2 1

IBC-04-07-00-00-S